

**Geberit Selnova urinal, trigonal, inlet from the rear, outlet to the rear or downwards**

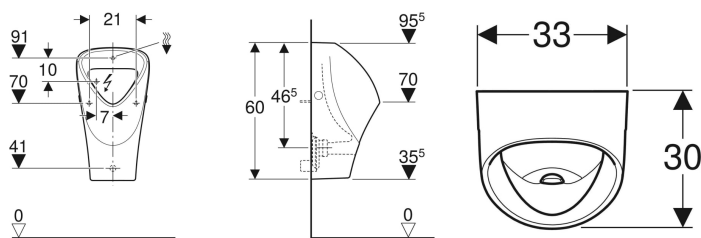

Example image



**Application purposes**

- For operating with automatic, water-saving flush
- For operation with manual or automatic flush actuation
- For concealed urinal flush controls
- For concealed urinal flush controls, hidden
- For exposed urinal flush controls, hidden

**Characteristics**

- Wall-hung

**Scope of delivery**

- Urinal ceramic

**To order additionally**

- Geberit fastening material for urinal, Kerafix
- Geberit fastening material for urinal, Kerafix

- With flush rim
- Hidden trap
- Hidden fastening
- Fulfils requirements in accordance with EN 13407

**Technical data**

Flush volume small, adjustment range	1 l
Product material	Vitreous china

Art. no.	Colour / surface	B	H	T	Inlet	Outlet
501.666.00.1	white	33 cm	60 cm	30 cm	rear	to the rear

**Accessories**

- Geberit urinal trap, horizontal outlet
- Geberit urinal division



- Electrical connection required for urinal flush controls with mains operation
- Trap not included in scope of delivery