

AXOR Uno

Select basin mixer for concealed installation wall-mounted 165

Surfaces: **Chrome** Article Number: **45112000**



Description

product features

- consists of: Single lever basin mixer for concealed installation wall-mounted, waste set
- projection 158 mm
- normal spray
- flow rate at 3 bar: 5 l/min
- Select valve
- separation of temperature control and open/close
- suitable for continuous flow water heaters
- non-closing waste set
- connection dimension: DN15
- handle can be positioned on the right or left, depends on the basic set installation

Technology



Design awards



Product image



Scale drawing

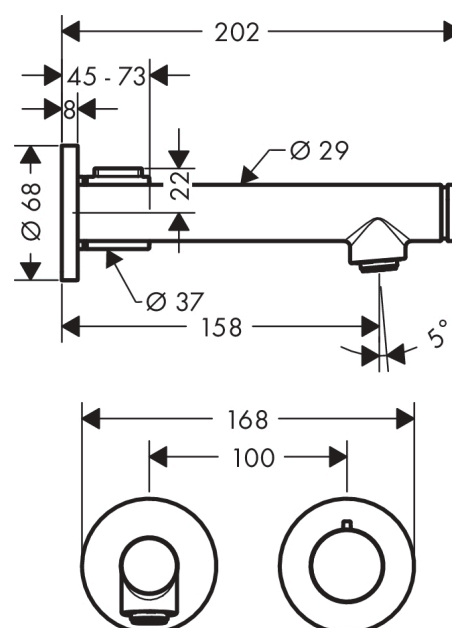

AXOR Uno

Select basin mixer for concealed installation wall-mounted 165

Surfaces: **Chrome** Article Number: **45112000**



Flowchart

