

Technical factsheet

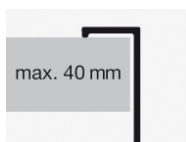

Built-in basin
EB.SR650H
SR series (Stream)

Item Number: 2219600000



Characteristics

Model description	EB.SR650H
Item Number	2219600000
Material basin	glazed steel
	white
Coating	ProShield
Dimensions	w/h/d 650 mm/127 mm/472 mm
Form	rectangular
Hole	with one tap hole
Overflow	with overflow
Net weight	7,7 kg
Mounting type	for installation from above

Fittings information Impact area 105 mm - 155 mm
middle tap hole

Optimal impact on the basin mould with fittings that have a vertical outlet (90 ° angle of impact) and a built-in aerator.

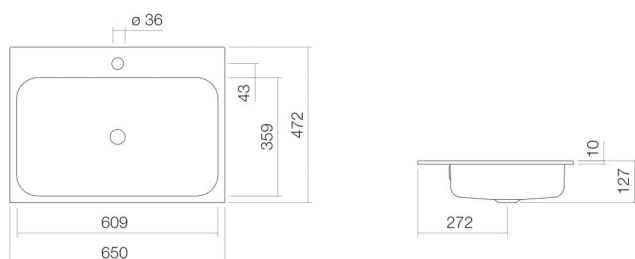

Product/tender specifications

Built-in basin

EB.SR650H

SR series (Stream)

Item Number:

2219600000

Text

Built-in basin, for installation from above, rectangular, w/h/d 650/127/472 mm, glazed steel, white, ProShield, with one tap hole, centred behind mould, with overflow, fixing set, overflow set
