

## A<sup>3</sup>form

### Technical data sheet



#### Washplaces

##### WP.PI3

Article number: 5033000000

Design partner: busalt design

#### Features

Description	WP.PI3
Article number	5033000000
Standard colour	White
Special surfaces	-
Construction	without tap hole, without overflow
Special versions	-
Dimensions	490 x 320 x 507mm
Material	Glazed steel
Net weight	5,3 kg
Installation	for wall connection
Accessoires	Mirror SP.300, Mirror SP.300.1, Mirror SP.300.2, Design mirror SP.FR375.S1
Tap fitting information	Optimum point of impact approx. 69 –109mm from rear edge of basin.

Tap fittings with a vertical outlet and aerator provide the optimum flow of water onto the surface below (angle of impact: 90°).

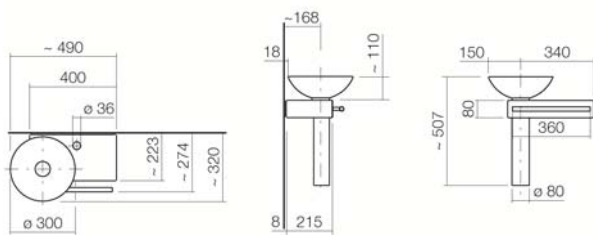

#### Text for invitation to tender

Washplace with a basin bracket, 300mm dish basin to the left, glazed inside and outside, white, without tap hole and overflow, with chrome-plated towel rail, drain valve and Bottle trap cover, including fixing set

Brand: Alape

Model: WP.PI3