

Geberit bathtub drain with turn handle and inlet, d52, length 26 cm, with ready-to-fit-set and straight connector

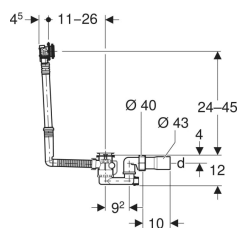

Example image

Application purposes

- For bathtubs made of steel, plastic or cast iron
- For standard-size bathtubs
- For bathtubs with valve hole \varnothing 52 mm

Characteristics

- Quality-monitored in accordance with EN 274-3
- With overflow and inlet
- Inlet jet can be aligned
- Double-sided seals on drain and overflow

Scope of delivery

- Waste outlet
- Trap
- Overflow head with inlet
- Elbow tap connector 90° with MasterFix, 1/2", radial-sealing

- Overflow head with extendible mount can be fastened

Technical data

Line noise at 3 bar	15 dB(A)
Sound class	1
Inlet capacity at 3 bar	0.35 l/s
Discharge rate	0.85 l/s
Overflow discharge rate	0.6 l/s
Depth of water seal	50 mm

- Straight connector made of PE-HD, \varnothing 43 mm
- Ready-to-fit set
- Protection box
- Fastening material

Art. no.	Colour / surface	DN	d, \varnothing	
150.712.21.6	gloss chrome-plated	40	40/43 mm	New

Accessories

- Geberit connection set for bathtubs made of acrylic, with overflow